

1. CONFIGURATION & DIMENSIONS :

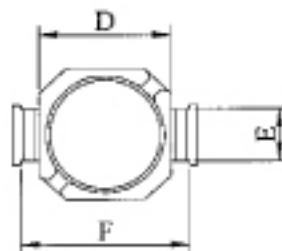

A	: 7.0±0.3	m/m
B	: 5.2±0.3	m/m
C	: 3.1 MAX	m/m
D	: 5.0±0.3	m/m
E	: 2.0±0.2	m/m
F	: 6.4±0.3	m/m
G	: 4.0 REF	m/m
H	: 2.5 REF	m/m
I	: 1.6 REF	m/m

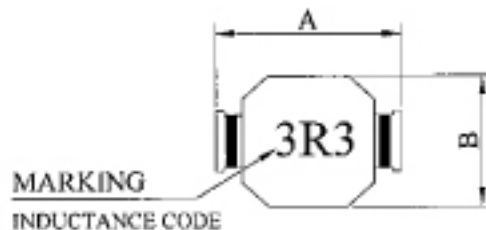
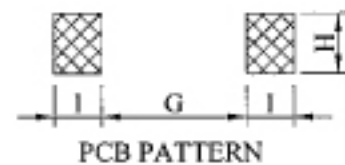

2. SCHEMATIC DIAGRAM :

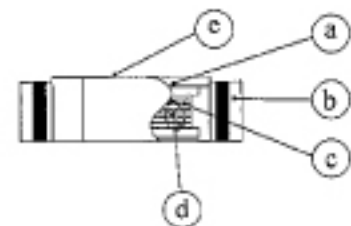
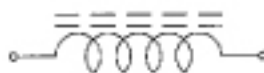

3. MATERIALS :

NO.	DESCRIPTION	SPECIFICATION	REMARK
a.	CORE	DR FERRITE CORE	
b.	BASE	PHENOLIC PM9630	
c.	WIRE	ENAMELLED COPPER WIRE 2UEW	
d.	ADHESIVE	EPOXY #6020H-6	

4. GENERAL SPECIFICATION :

- TEMP. RISE : 40°C TYP. AT IDC
- RATED CURRENT : $\Delta I / L0A = 10\%$ MAX. AT IDC
- OPERATING TEMP. : -40°C ~ +85°C
- RESISTANCE TO SOLDER HEAT : 260°C. 10 SECS.



RoHS Compliant

Description : SMD POWER INDUCTORS (LEAD FREE)

DATE : 09.03.2007

Unit: MM

Scale: NTS

Page

DWG No. : C:\20\SWDH1608-3R3MXF.DWG

Checked

By :

Approved

By :

09 MAR 2007

CONTROLLED COPY

	CUSTOMER P/N : CE-BO00007	SAMPLE QTY : NIL
SWDH1608-3R3MXF	SAMPLE No.: SWS-51111	REVISION : 0

5. ELECTRICAL CHARACTERISTICS :

Part No.	INDUCTANCE (μ H)	TEST FREQ. (HZ)	RDC (mOhm) MAX	SRF (MHz) TYP.	IDC (A)
SWDH1608-1R0MXF	1.0 \pm 20%	0.1V / 100K	40	180	2.90
SWDH1608-1R5MXF	1.5 \pm 20%	0.1V / 100K	45	130	2.50
SWDH1608-2R2MXF	2.2 \pm 20%	0.1V / 100K	55	100	2.00
✓ SWDH1608-3R3MXF	3.3 \pm 20%	0.1V / 100K	65	80	1.70
SWDH1608-4R7MXF	4.7 \pm 20%	0.1V / 100K	90	60	1.50
SWDH1608-6R8MXF	6.8 \pm 20%	0.1V / 100K	100	50	1.20
SWDH1608-100MXF	10.0 \pm 20%	0.1V / 100K	160	40	1.10
SWDH1608-150MXF	15.0 \pm 20%	0.1V / 100K	210	30	0.90
SWDH1608-220MXF	22.0 \pm 20%	0.1V / 100K	370	20	0.70
SWDH1608-330MXF	33.0 \pm 20%	0.1V / 100K	500	15	0.60
SWDH1608-470MXF	47.0 \pm 20%	0.1V / 100K	710	13	0.50
SWDH1608-680MXF	68.0 \pm 20%	0.1V / 100K	950	11	0.40



RoHS Compliant

Description : SMD POWER INDUCTORS (LEAD FREE)	DATE : 09.03.2007	Unit: -	Scale: -	Page
DWG No. : C:\20\SWDH1608-3R3MXF.DWG		Checked By: <i>[Signature]</i>	Approved By: <i>[Signature]</i>	09 MAR 2007

CONTROLLED COPY